



# Building Today for Tomorrow:

Method 22·26 combines  
economy and ecology

Climate change and the energy transition require quick and consistent rethinking in the construction sector. Energy-efficient, sustainable buildings are in higher demand than ever before. To conserve resources, optimise costs and reduce emissions, a comprehensively sustainable concept is needed: Method 22:26 was developed to create economically and ecologically optimised solutions for sustainable construction. Premiered in 2013 with a building in Lustenau, Austria, the method has now proven its viability again and again. Accordingly, there is a growing interest in the construction world along with investors and political stakeholders.

## Sustainability, longevity and comfort:

### The time has come for method 22:26

At its core, the method is focused on utilising energy from the environment more efficiently. 22:26 buildings maintain a comfortable temperature of between 22 °C and 26 °C all year round—without the need for conventional heating, ventilation or cooling systems. Instead, intelligent control software ensures a consistently pleasant indoor climate—software is replacing hardware. In addition to its ease of use, method 22:26 offers impressive value-optimisation potential in terms of construction costs, energy efficiency and life cycle costs.

Axel Meier, Managing Director of 2226 GmbH, sees great potential for method 22:26® products:

*“Considering the trends and circumstances in Europe, such as high energy prices and CO2 awareness, such an idea is crucial. The solution approach method 22:26 is now fully matured and suitable for large-scale implementation.”*

## Method 22:26 is causing a stir in the construction industry

Method 22:26 is developed and marketed by 2226 GmbH, a service and software company that specialises in designing energy-efficient and sustainable construction projects. By applying method 22:26, we aim to promote change in the construction industry and help establish sustainable construction as an industry standard. Our goal is to use innovative construction concepts to conserve resources, reduce CO2 and, at the same time, save costs. 22:26 buildings are not just future-proof but investments in the future that create a long-lasting, comfortable environment.

Elmar Hasler, CEO of :be AG, sees a bright and successful future for method 22:26 and 2226 GmbH:

*“Irrespective of political discussions about technological alternatives to fossil-fuel based heating, we have developed a visionary concept with method 22:26 that is ready for series production and can be widely marketed. It is an ecologically, economically and socially conscious answer to the move towards sustainability, integrating all aspects of the circular economy and offering reliable starting points for existing buildings worth preserving with regard to future-proofing them holistically.”*

# 2226 GmbH: Company profile

2226 GmbH has been active as a service company for more than 10 years, designing energy-efficient and sustainable construction projects by applying the groundbreaking method 22-26. By means of innovative combinations of specific building structures and intelligent control software, method 22-26 can create economically and ecologically optimised solutions that can effectively meet the challenges of modern construction.

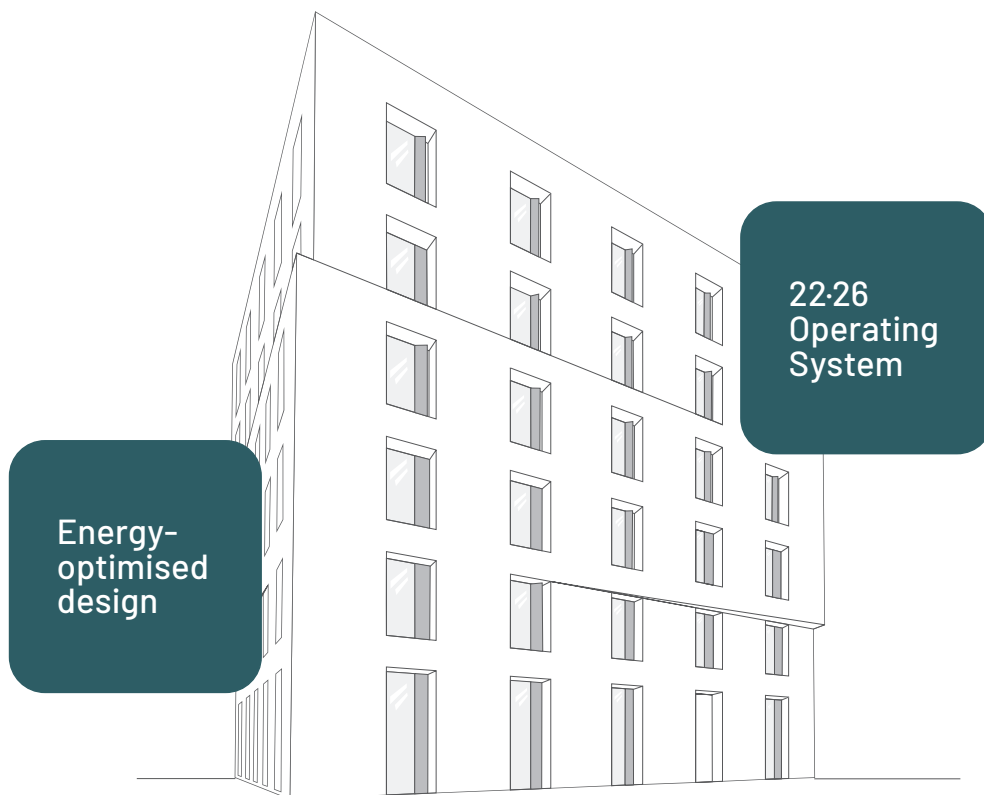

## Vision

It all began with a vision of a building that needed no heating or cooling. A building for people that offers atmosphere and constantly well-tempered interiors—always at the universally accepted comfortable temperature of 22 °C to 26 °C. With method 22-26, this vision has become a reality, and its name has become a promise.

By applying method 22-26, we aim to promote change in the construction industry and help establish sustainable construction as an industry standard. Our goal is to use innovative construction concepts to conserve resources, reduce CO<sub>2</sub> and, at the same time, save costs. 22-26 buildings are not just future-proof, but investments in the future that provide a long-lasting, comfortable environment.

# 2226 GmbH offers comprehensive support throughout all phases of a 22-26 construction project

2226 GmbH accompanies method 22-26 construction projects, offering valuable advice and insights from first analyses to the documentation of a completed 22-26 building.

## Performance phases at a glance

### 1 Analyse

We define comfort and energy goals based on comprehensive location analyses, our knowledge of building physics and well-founded empirical values.

### 2 Planning

During the planning phase, we collaborate closely with the commissioned architects. Among other things, we determine year-round thermal protection, optimise the building envelope, determine the comfortable indoor climate and offer advice on the choice of construction materials.

### 3 Simulation

Using thermal-dynamic simulations based on method 22-26, we examine the building concept to determine whether there is a potential need for backup systems for exceptional situations.

### 4 Operation

We monitor the implementation of all system decisions defined during design planning, coordinate between the relevant parties and oversee the entire approval process. We supply the control software for the building's system operation, supervise commissioning and submit quarterly reports for each 22-26 building.

**Axel Meier, Managing Director of 2226 GmbH:**

*„A 22-26 building works as low-tech as possible and does without large heating, ventilation and cooling systems. These hardware HVAC systems are replaced with intelligent control software.“*

# Method 22-26: The success story since 2013

Since the completion of “House 2226”, the method 22-26 prototype in Lustenau in 2013, a further 40 projects have reached the planning, construction or completion phase. To date, method 22-26 buildings have been implemented in Austria, Germany, Switzerland, France, Belgium, Luxembourg and Italy.

## Suitable for various typologies, architectural styles and construction modes

Method 22-26 is scalable and can therefore be applied to various building typologies along with a wide variety of architectural styles and modes of construction. It is suitable in the following typologies:

**Residential:** A 22-26 building saves energy costs and offers the highest level of sleeping comfort at night thanks to excellent air quality and pleasant temperatures. Individual backup solutions are available to ensure constant hot water supply and additional heat input in winter.

**Office:** With the room-booking function, conference rooms automatically and autonomously optimise room conditions for upcoming meetings in advance. Additionally, sustainable office buildings are shown to reflect positively on a company’s employer branding and ESG efforts.

**Education:** The best possible room conditioning is crucial for successful learning, teaching and growing. Well-tempered halls, fresh air and isolation from disturbing ambient noise have been proven to promote concentration and thus learning success.

**Renovation:** It is usually possible to update historic buildings quickly and easily. Various measures can be taken to ensure that any monument preservation or other historic protection regulations are met.

Method 22-26 can be applied to a wide variety of architectural styles and modes of construction. This makes it an interesting option for architects, investors, project developers, real estate companies and institutional developers alike. 2226 GmbH accompanies method 22-26 construction projects, offering valuable advice and insights throughout all phases of a project, from initial analyses to documentation of a completed 22-26 building.

# Completed buildings that were designed according to method 22:26

## Haus 2226, Lustenau, Austria

Since completing construction in 2013, the pilot building in Lustenau has become an impressive demonstration of the savings potential inherent in method 22:26. Today, it also serves as the headquarters of 2226 GmbH.



## 2226 Emmenweid, Emmenbrücke, Switzerland

Completed in 2018 in accordance with method 22:26 designs, this building is a manifesto for sustainable construction, mindful implementation in terms of urban planning, and a first for Switzerland in terms of energy sustainability.



## 2226 Lingenau, Austria

This method 22:26 building, completed in 2019, highlights the diverse possibilities of method 22:26 in terms of design vocabulary and facade design.



# Completed buildings that were designed according to method 22:26

## JED Schlieren, Switzerland

22:26 on a new scale.



## 2226 Graf Dornbirn, Austria

The first residential building designed according to method 22:26, completed in 2020, does not require conventional heating.



## ROBIN Seestadt Aspern, Vienna, Austria

Mixed use according to method 22:26.

# Buildings designed according to method 22:26 currently under construction, selection

## Amber – Renovation at Universitätstrasse, Zurich, Switzerland

Renovating within the existing structure  
based on the method 22:26 – Luxurious  
office refurbishment in Zurich  
Completion: October 2025



## 2226 Confluence Lyon, France

A first for France: Residential living  
according to method 22:26.  
Completion: 2025



## Steigerwaldstraße, Ingolstadt, Deutschland

Climate-resilient living in southern  
Germany – a new residential building  
based on the method 22:26  
Completion: 2025

## WAS Building Lucerne, Switzerland

The largest property to date  
according to method 22:26.  
Completion: 2025



# Buildings designed according to method 22:26 currently under construction, selection

## Kornelius Forum, Berlin, Germany

German première for the innovative 22:26 construction method  
Completion: 2026

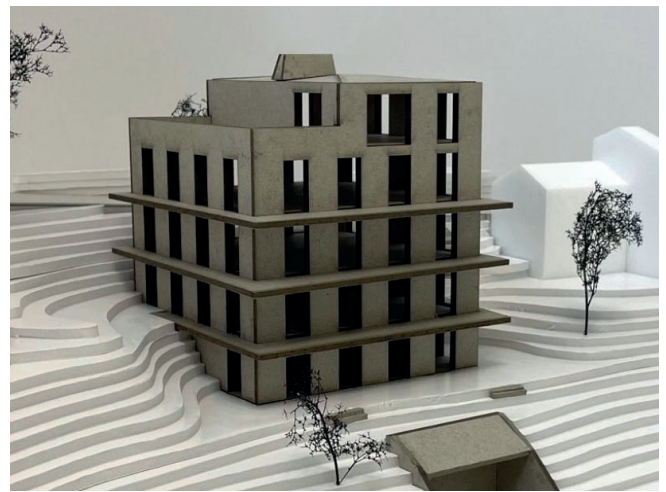

## Salzfaß, Lucerne, Switzerland

With the 22:26 Salzfaß project, the first residential building in Switzerland based on the method 22:26 will be built  
Completion: 2026



## Multifunctional Building Complex KITA Nordstraße, Leipzig, Germany

Pioneering and child-friendly - the first daycare center following the method 22:26  
Completion: expected in 2027



**Elmar Hasler**

Dipl. Arch. (FH) Elmar Hasler has been working for Baumschlager Eberle Architekten since 1992. He is project manager, overall project manager and Member of the Board of Management of the Baumschlager Eberle Group. Since 2008, he has been Managing Director of the St. Gallen office, and since December 2020, he has been CEO of :be AG.



**Axel Meier**

Alex Meier has more than 25 years of experience in selling complex IT solutions and projects. For more than three years, he has been closely involved with method 22-26 and its operations. Since January 2024, he has been Managing Director of 2226 GmbH.

# Press contact



**Claudia Schwind**

**BE Services | Head of communications**

7, rue Debelleye

75003 Paris, Frankreich

T+33 7 85 46 51 02

c.schwind@be-architects.fr

Languages DE | EN | FR | IT

## **Copyright photography / renderings**

Eduard Hueber, René Dürr, Alexandre Besson,

Baumschlager Eberle Architekten

Architekturbüro Gigon / Guyer

Maximilian Haidacher, Büro Lindenkreuz Eggert

: nbundm\* Architekten, OST Renders

## **Copyright Projekte**

Baumschlager Eberle Architekten

Gigon / Guyer Architects (WAS, Luzern, Switzerland)

h.e.i.z.Haus, Architektur. Stadtplanung

(Multifunctional Building Complex KITA Nordstraße, Leipzig, Germany)

: nbundm\* Architekten (Steigerwaldstraße, Ingolstadt, Germany)

## **:be AG**

is a holding company with operational focus on investments in architecture and real estate companies in Europe and Asia.

Their core brands are Baumschlager Eberle Architekten and 2226 GmbH.

## **2226 GmbH**

has been active as a technology service provider for over 10 years and currently has four locations. Their specialty is planning and implementing buildings according to the innovative method 22-26 along with selling the associated control software. The method 22-26 planning and control approach ensures maximum thermal comfort with optimised energy savings.

With method 22-26, :be AG has a USP in the sustainability sector.

## **2226 GmbH**

Millennium Park 20

6890 Lustenau

Austria

office@2226.eu



[www.2226.eu](http://www.2226.eu)

building • tomorrow • today